

## Hey event attendee!

We are excited to welcome you to the biggest hacker event in the Nordics, Disobey 2020! Here's a couple of things we wanted to share with you before the event, to make sure everything goes smoothly!

## Arrival at the venue

The event venue Kaapelitehdas ("Cable Factory" in English) is located in Ruoholahti, Tallberginkatu 1 C 15, 00180 Helsinki. The entrance is through the inner courtyard through door M2. There are multiple convenient ways to arrive at the location.

If unsure how to reach the venue, check Helsinki's local traffic in [hsl.fi](http://hsl.fi) or via HSL app.

### Metro

Don't worry, there's only one metro line in Helsinki. Take either metro M1 or M2, depending on the direction of your travel and get off at Ruoholahti metro station. After exiting the metro station, walk for 10-15 minutes to reach Kaapelitehdas.

### Tram

Take the tram number 8 and get off at Kaapelitehdas tram stop. Walk for 4 minutes to reach Kaapelitehdas.

### Bus

Busses number 20 and 21 stop close by to Kaapelitehdas.

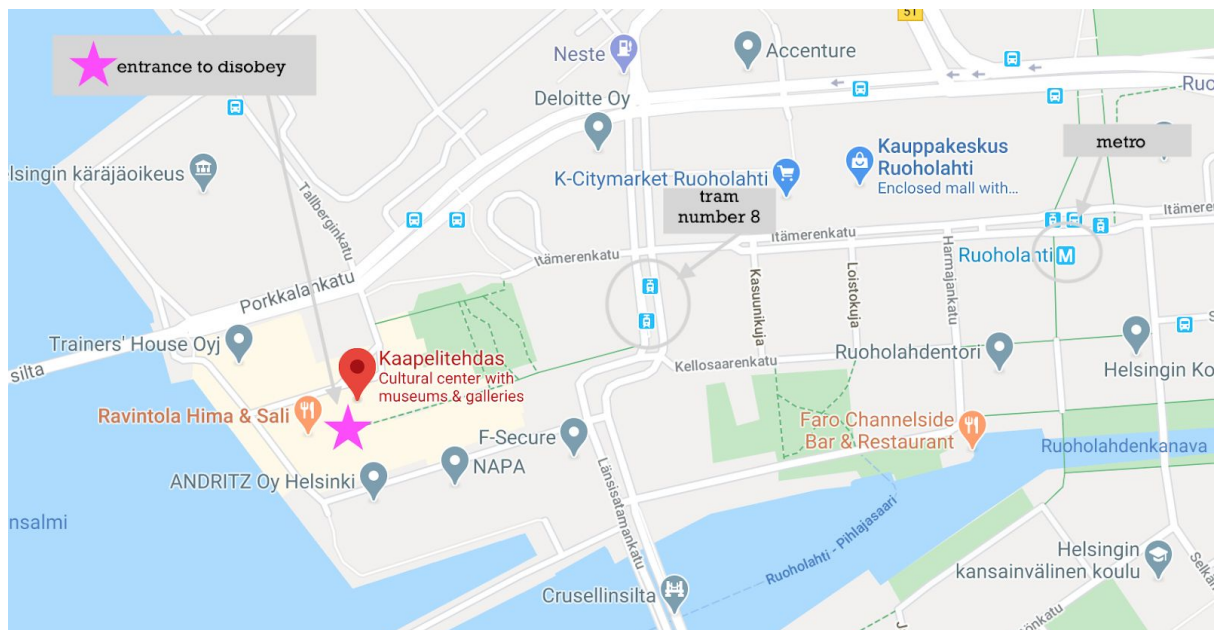

## Claiming your ticket

If you have a support, hacker or user badge ticket purchased through Holvi, there are four lanes for you. In all other cases, join the fifth lane for Special Circumstances. Using the four lanes, to speed things up, please follow these simple instructions:

1. Bring your **ticket receipt** from Holvi with you!
2. Tickets can be claimed starting at 11:30 on Friday, but if you wish to avoid rush hour, arrive an hour or two later
3. Pick a lane depending on the first letter of your surname
4. Have your (\*) ticket receipt ready: we are interested in
  - a. your badge type
  - b. last name
  - c. first name, and
  - d. RECEIPT number
5. We'll give you a goodie bag including badge and bracelet
6. Use the cloakroom if you need it
7. Attach your bracelet to your wrist and enter Disobey! Welcome!

(\*) The first and last name on the ticket receipt. When a person bought multiple tickets, they all share the same name. Applies also if the ticket has been give/sold to someone else. We don't check ID except in special circumstances.

The **purple arrows** below show the formation of the queue during rush hour.

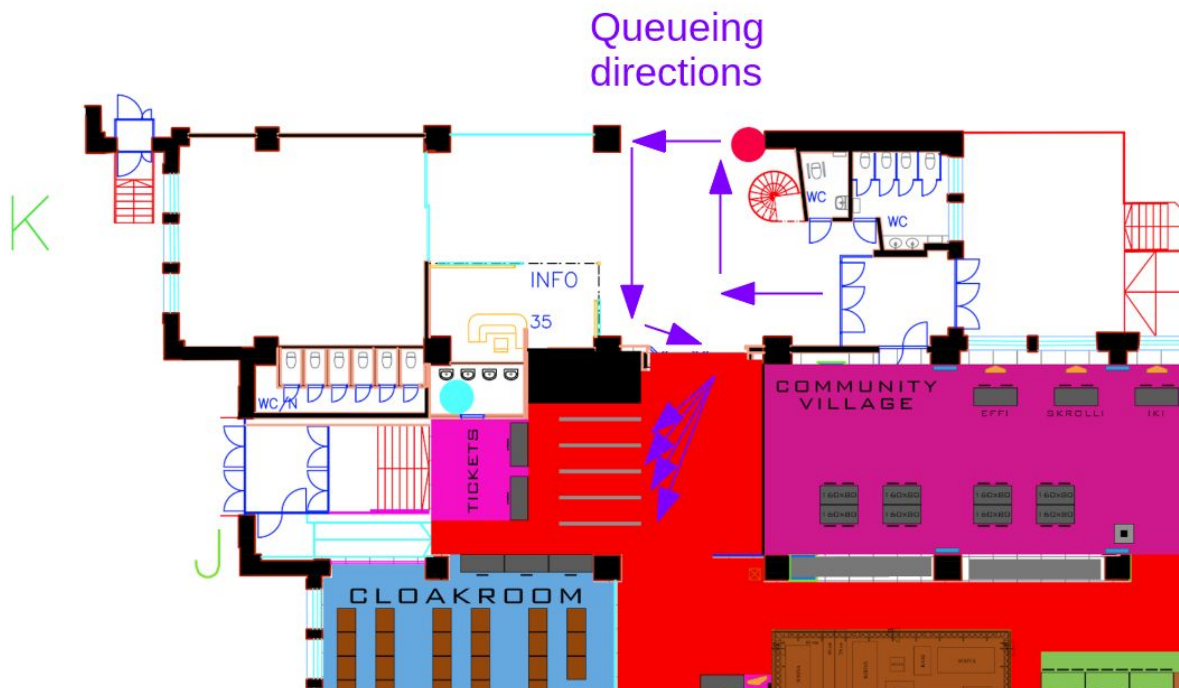

## **Social Media**

For all Disobey events we have employed the Chatham House Rule, which in our case means that we wish that you **do not** take pictures during your visit to Disobey. There may be areas in Disobey where pictures are taken by those employed by Disobey or Disobey partners, but taking pictures of the other attendees, presenters or workshops is not allowed.

## **Code of Conduct**

Don't be an asshole.

OR

Be nice.

Be encouraging.

Be accepting.